



**WINDOOR** 2024  
V1

## TABLE OF CONTENTS//

NOTATION / TYPES OF VENEERS .....	1	LACQUERED DOORS .....	28
TYPES OF VENEERS / POLIPROPYLENE .....	2	ARIES .....	28
DOOR CONSTRUCTION .....	3	DORADO .....	28
NON-REBATED DOORS .....	4	GEMINI .....	28
VSG BLACK GLASS .....	5	INDUS .....	28
SLIM SERIES .....	6	ENTRANCE DOORS .....	29
MINORIS .....	6	CALISTO .....	29
PEGASUS .....	6	ARA SET .....	30
ELEGANCE .....	6	TEA SET .....	30
PRIM .....	6	ANDROMEDA .....	31
CHICAGO .....	6	ORION SET .....	31
PRESTIGE SERIES .....	7	DOOR FRAMES .....	32
LOFT ELEGANCE .....	7	FIXED REBATED DOOR FRAME .....	32
LAMELLA .....	7	REBATED ADJUSTABLE DOOR FRAME .....	33
ELEGANCE .....	8	NON-REBATED ADJUSTABLE DOOR FRAME .....	34
LIMES .....	9	SLIDING SYSTEM .....	35
PEGASUS .....	10	LAMELLAS .....	36
CHICAGO .....	11	BASEBOARD .....	36
APUS .....	12		
PRIM .....	13		
CORVUS .....	14		
MENSA .....	15		
MINORIS .....	16		
TRAME .....	17		
CREDIS .....	17		
VIRGO .....	18		
SYRIUSZ .....	18		
TRE .....	19		
DALIA .....	19		
FIORE .....	20		
DRACO .....	20		
FUTURO .....	21		
PANEL DOORS .....	22		
CANIS .....	22		
SERPENS .....	23		
OLGA .....	24		
ZETA .....	24		
TRIO .....	24		
ALBATROS .....	25		
ROCO .....	25		
CERES .....	25		
MEMPHIS .....	26		
PRESTO .....	26		
KARINA .....	26		
CERES 2 .....	27		
CLASSIC .....	27		
WEGA .....	27		



NOTATION //



**REBATED DOOR**  
THE WING HAS A REBATE (INDENTATION, FITTING NOTCH) WHICH OVERLAPS THE DOOR FRAME.



**NON-REBATED DOORS**  
THE LEAF DOES NOT HAVE A FEEL DOOR LEAF WITH A FRAME CREATES A UNIFORM SURFACE.

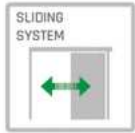

**SLIDING SYSTEM**  
POSSIBILITY OF APPLICATION IN A SLIDING SYSTEM.

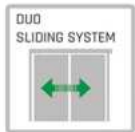

**DUO SLIDING SYSTEM**  
POSSIBILITY OF APPLICATION IN A DUO SLIDING SYSTEM.



**BLACK GLASS VSG**  
GLOSSY BLACK GLASS ON BOTH SIDES INSTEAD OF MILK GLASS.



**DESIGN: MDF**  
FRAME DOORS MADE OF HIGH QUALITY MDF BOARD.



**SLIM VERSION**  
MODIFICATION OF THE MDF CONSTRUCTION TO REDUCE THE LOAD ON THE HINGES.

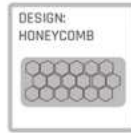

**DESIGN: HONEYCOMB**  
PLATE FRAME, FILLED BY LAYER WITH "HONEYCOMB" STRUCTURE.



**DESIGN: SOLID**  
DOUBLE PLATE FRAME, FILLED WITH SOFTENING BOARD SOLID CONSTRUCTION.

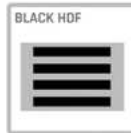

**BLACK HDF**  
INSTEAD OF MILK GLASS FILLED WITH BLACK HDF PLATE.

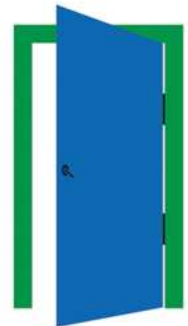

RIGHT DOOR

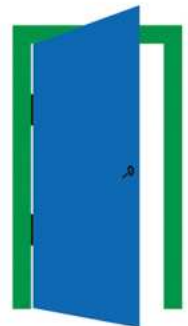

LEFT DOOR

STANDARD VENEERS //

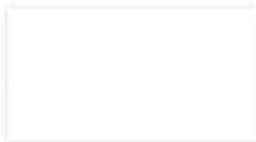

WHITE



SILVER



SONOMA



WALNUT

PREMIUM VENEERS //



GRAY ASH



GRAY OAK



GRAPHITE



TRUFFLE



DARK CONCRETE



BLACK



GRAY



NORTH WALNUT



COUNTRY OAK



MOUNTAIN OAK



SCANDINAVIAN OAK



JAPANESE OAK



EUCALYPTUS

## POLYPROPYLENE VENEER//



DUB GRANDSON



RIBEIRA

A decorative polypropylene (PP) based film is an eco-friendly product. Its surface is protected by a transparent heat-cured coating to protect it from abrasion, scratching and chemical influences.

### DOORS AVAILABLE IN PP VENEER

- |            |           |
|------------|-----------|
| ■ CHICAGO  | ■ MENSA   |
| ■ CORVUS   | ■ MINORIS |
| ■ CREDIS   | ■ SYRIUSZ |
| ■ ELEGANCE | ■ TRAME   |
| ■ PEGASUS  | ■ TRE     |
| ■ PRIM     | ■ VIRGO   |

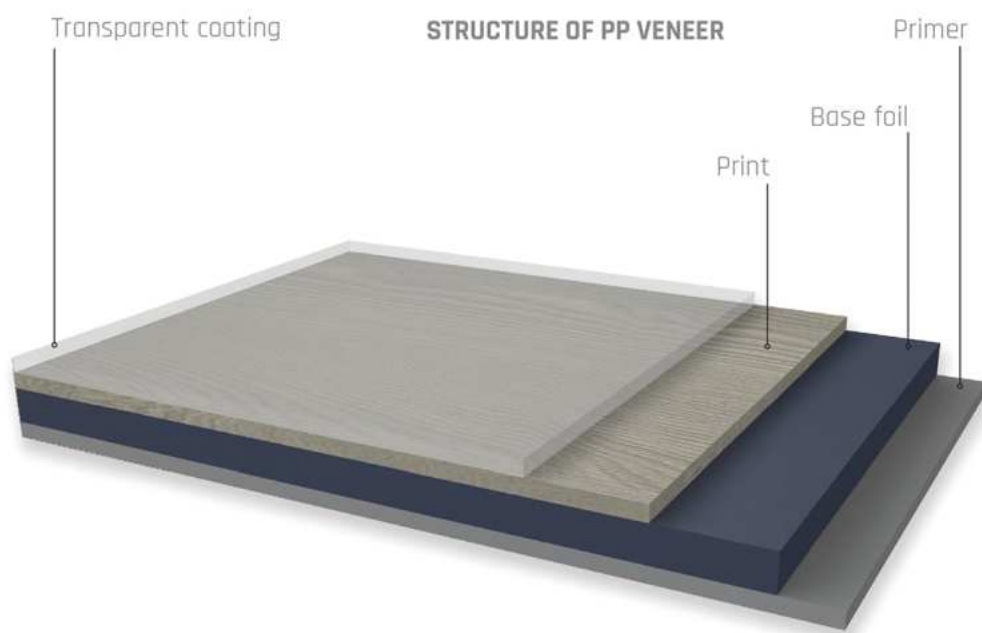

### CHARACTERISTICS OF PP VENEER

- scratch resistant
- abrasion resistant
- chemical resistant
- water resistant
- vapour resistant
- mould resistant
- light resistant
- easy to clean
- formaldehyde and heavy metal free

### ECO-FRIENDLY PRODUCT

The PP veneers used by WINDOOR offer eco-friendly features:

- formaldehyde-free
- halogen-free
- plasticiser-free

The product also has other positive environmental properties:

- made of harmless pigments
- low-emission waste disposal using incineration

The composition and production of PP veneers fully comply with the REACH regulation.

### DOOR CONSTRUCTION//

WINDOOR doors are manufactured in three basic types of construction: MDF frame, honeycomb and SOLID. Due to a wide range of solutions used, the product can be freely adjusted to meet specific customer needs.



**CONSTRUCTION  
MDF**

Prestige and SLIM series interior doors made of solid MDF.



**CONSTRUCTION  
SOLID**

Interior doors with double frame and SOLID acoustic panel.



**CONSTRUCTION  
HONEYCOMB**

Internal panel door with a frame filled with a layer of so-called honeycomb structure.

### FRAME DOOR CONSTRUCTION//

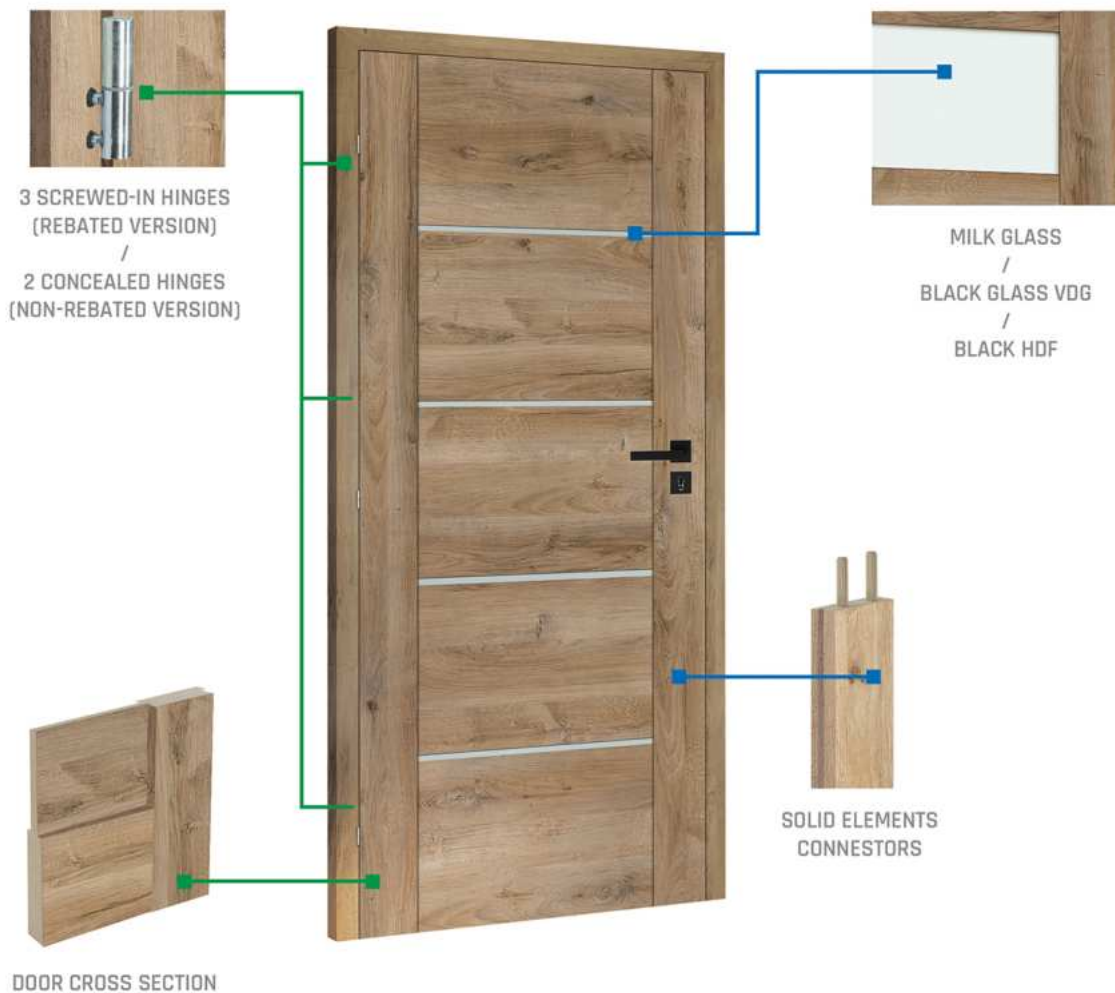



## NON-REBATED DOORS//



REBATED DOORS



NON-REBATED DOORS

A non-rebated door together with a dedicated frame creates a single plane, merging visually into the wall. That is what distinguishes a non-rebated door from a standard rebated door.

The rebated system is equipped with so-called screwed-in hinges, which are visible both when the door is closed and when it is opened. Assuming that the door is opened "towards your direction".

Doors in the non-rebated system are installed in the door frame on dedicated concealed hinges, which are not visible both when the door is closed and when it is opened.

Non-rebated doors have no notch (groove) overlapping the frame casing when the door is closed.



NO REBATE VISIBLE



CONCEALED HINGE

## MODELS OF NON-REBATED DOORS

- PRESTIGE SERIES
- LACQUERED DOORS
- SLIM SERIES
- CANIS

## VSG BLACK GLASS//



VSG black glass is a laminated glass, produced by permanent bonding of two panes of glass with a bonding film.

Between the two panes of glass, the black bonding film is used to hold any fragments when the glass is broken, creating a "spider web".

## DOORS AVAILABLE WITH BLACK VSG GLASS

- |           |           |
|-----------|-----------|
| ■ CHICAGO | ■ MINORIS |
| ■ CORVUS  | ■ PEGASUS |
| ■ LIMES   | ■ PRIM    |

The VSG glass used by WINDOOR can withstand high stresses and loads.

This product has many beneficial properties:

- greater safety (eliminates the risk of injury if broken)
- durability of construction
- higher resistance to breaking (glass does not break into small pieces)



SLIM SERIES //



The SLIM series is a new collection of WINDOOR interior doors that is characterised by a slimmer design due to the narrower width of the vertical frames but distinguished by a different construction method.

PRESTIGE SERIES

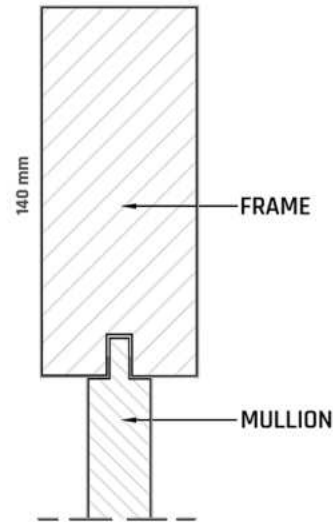

SLIM SERIES

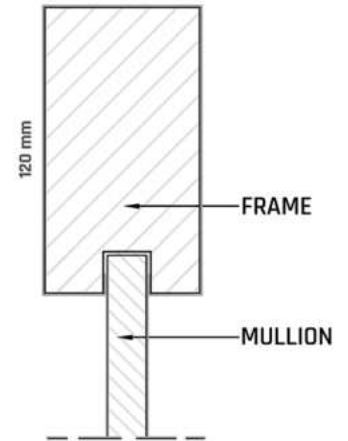

The SLIM series doors have many positive properties:

- slimmer design
- less weight
- less load on the hinges

DOOR MODELS AVAILABLE IN SLIM VERSION



MINORIS

PEGASUS

ELEGANCE

PRIM

CHICAGO

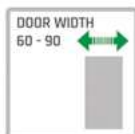



LOFT ELEGANCE//



LOFT ELEGANCE

Loft doors are a stylish and modern solution that adds character to any interior, perfectly matching the raw, industrial atmosphere of loft spaces.

The main feature of loft doors is a large glass surface, allowing light to flow in and optically enlarging the room. The LOFT ELEGANCE model is available in two glazing options: transparent or satin.

We recommend the loft sliding system visible in the photo when purchasing a sliding door leaf.



WHITE



BLACK



EUCALYPTUS



MOUNTAIN OAK

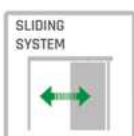
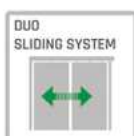
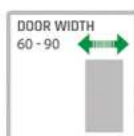

LAMELLA//



LAMELLA MOUNTAIN OAK

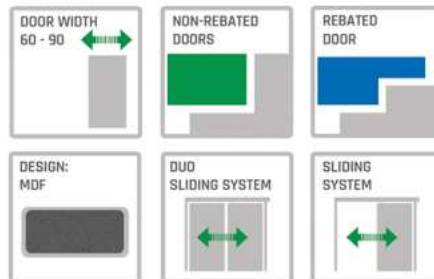

LAMELLA DOOR FILLING

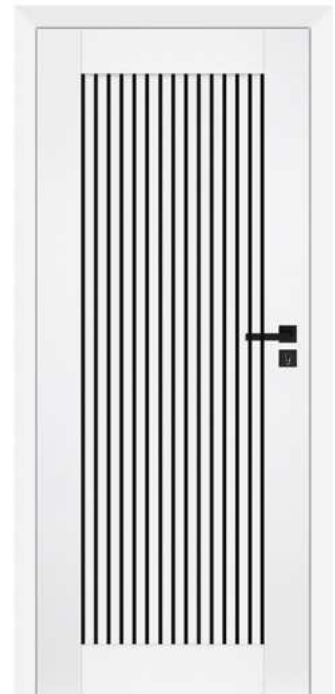

LAMELLA WHITE



ELEGANCE//



FULL

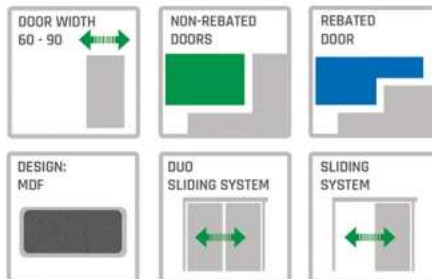

**BESTSELLER**



BATHROOM



LIMES//



<p>DOOR WIDTH 60 - 90</p>	<p>NON-REBATED DOORS</p>	<p>REBATED DOOR</p>
<p>DESIGN: MDF</p>	<p>DUD SLIDING SYSTEM</p>	<p>SLIDING SYSTEM</p>
<p>BLACK HDF</p>	<p>BLACK GLASS VSG</p>	

**BESTSELLER**

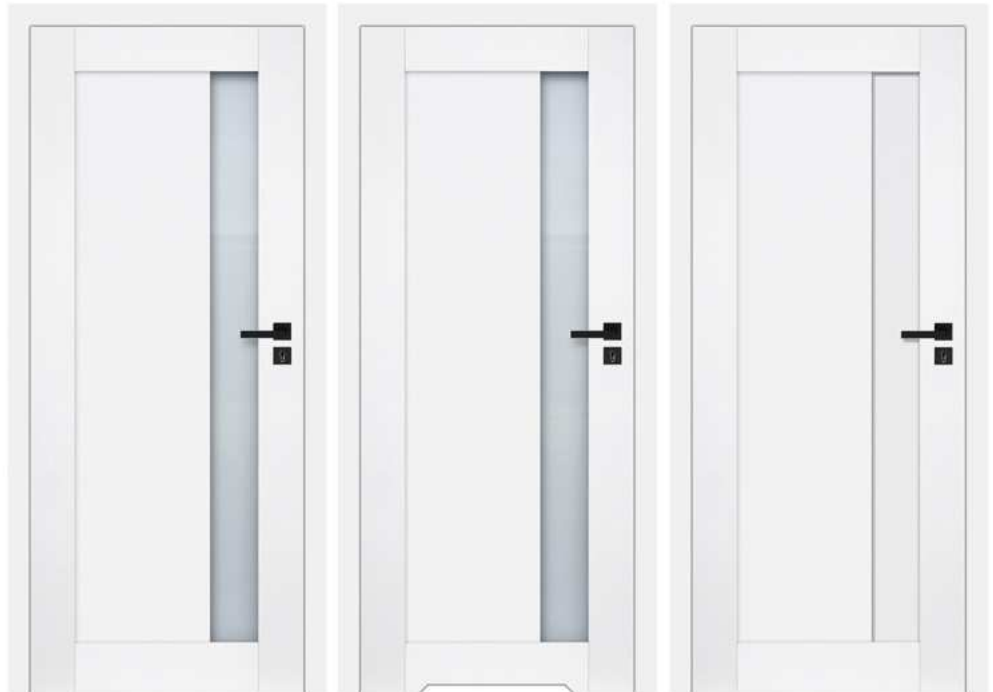

ROOM

BATHROOM

FULL





PEGASUS//



<p>DOOR WIDTH 60 - 100</p>	<p>NON-REBATED DOORS</p>	<p>REBATED DOOR</p>
<p>DESIGN: MDF</p>	<p>DVD SLIDING SYSTEM</p>	<p>SLIDING SYSTEM</p>
<p>BLACK HDF</p>	<p>BLACK GLASS VSG</p>	

**BESTSELLER**



ROOM

BATHROOM

FULL



CHICAGO//



<p>DOOR WIDTH 60 - 100</p>	<p>NON-REBATED DOORS</p>	<p>REBATED DOOR</p>
<p>DESIGN: MDF</p>	<p>DVD SLIDING SYSTEM</p>	<p>SLIDING SYSTEM</p>
<p>BLACK HDF</p>	<p>BLACK GLASS VSG</p>	

**BESTSELLER**



ROOM

BATHROOM

FULL





APUS//



<p>DOOR WIDTH 60 - 100</p>	<p>NON-REBATED DOORS</p>	<p>REBATED DOOR</p>
<p>DESIGN: MDF</p>	<p>DVD SLIDING SYSTEM</p>	<p>SLIDING SYSTEM</p>
<p>BLACK HDF</p>		

**BESTSELLER**



ROOM

BATHROOM

FULL



PRIM//



<p>DOOR WIDTH 60 - 100</p>	<p>NON-REBATED DOORS</p>	<p>REBATED DOOR</p>
<p>DESIGN: MDF</p>	<p>DVD SLIDING SYSTEM</p>	<p>SLIDING SYSTEM</p>
<p>BLACK HDF</p>	<p>BLACK GLASS VSG</p>	

**BESTSELLER**



ROOM

BATHROOM

FULL





CORVUS//



<p>DOOR WIDTH 60 - 100</p>	<p>NON-REBATED DOORS</p>	<p>REBATED DOOR</p>
<p>DESIGN: MDF</p>	<p>DVD SLIDING SYSTEM</p>	<p>SLIDING SYSTEM</p>
<p>BLACK HDF</p>	<p>BLACK GLASS VSG</p>	



ROOM



BATHROOM



FULL

WHITE	SILVER	SONOMA	GRANDSON OAK	MOUNTAIN OAK	COUNTRY OAK	RIBEIRA	GRAY OAK	GRAPHITE	NORTH WALNUT	DARK CONCRETE	GRAY ASH



MENSA//



<p>DOOR WIDTH 60 - 100</p>	<p>NON-REBATED DOORS</p>	<p>REBATED DOOR</p>
<p>DESIGN: MDF</p>	<p>DVD SLIDING SYSTEM</p>	<p>SLIDING SYSTEM</p>
<p>BLACK HDF</p>		

**BESTSELLER**



ROOM

BATHROOM

FULL



MINORIS//



<p>DOOR WIDTH 60 - 100</p>	<p>NON-REBATED DOORS</p>	<p>REBATED DOOR</p>
<p>DESIGN: MDF</p>	<p>DVD SLIDING SYSTEM</p>	<p>SLIDING SYSTEM</p>
<p>BLACK HDF</p>	<p>BLACK GLASS VSG</p>	

**BESTSELLER**

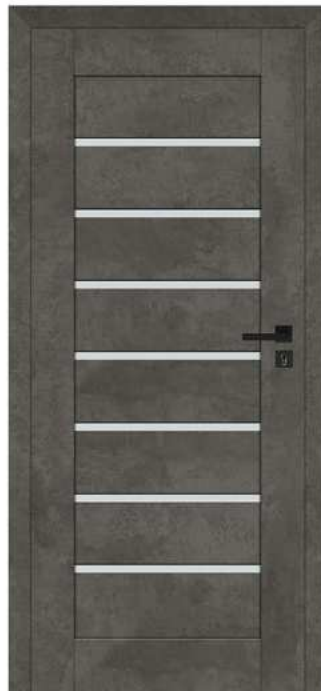

ROOM



BATHROOM



FULL





### TRAME//

DOOR WIDTH 60 - 100

NON-REBATED DOORS

REBATED DOOR

DESIGN: MDF

DUO SLIDING SYSTEM

SLIDING SYSTEM

BLACK HDF



ROOM

BATHROOM

FULL



### CREDIS//

DOOR WIDTH 60 - 100

NON-REBATED DOORS

REBATED DOOR

DESIGN: MDF

DUO SLIDING SYSTEM

SLIDING SYSTEM

BLACK HDF



ROOM

BATHROOM

FULL





**VIRGO//**

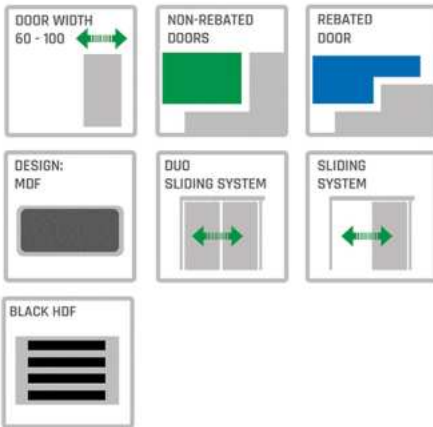

ROOM



BATHROOM



FULL



**SYRIUSZ//**

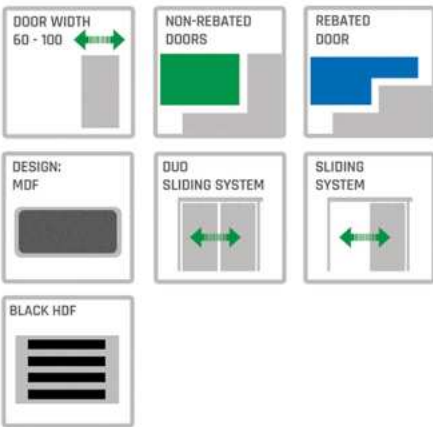

ROOM



BATHROOM



FULL



TRE//

DOOR WIDTH 60 - 100

NON-REBATED DOORS

REBATED DOOR

DESIGN: MDF

DUO SLIDING SYSTEM

SLIDING SYSTEM

BLACK HDF



ROOM

BATHROOM

FULL



DALIA//

DOOR WIDTH 60 - 100

NON-REBATED DOORS

REBATED DOOR

DESIGN: MDF

DUO SLIDING SYSTEM

SLIDING SYSTEM

BLACK HDF

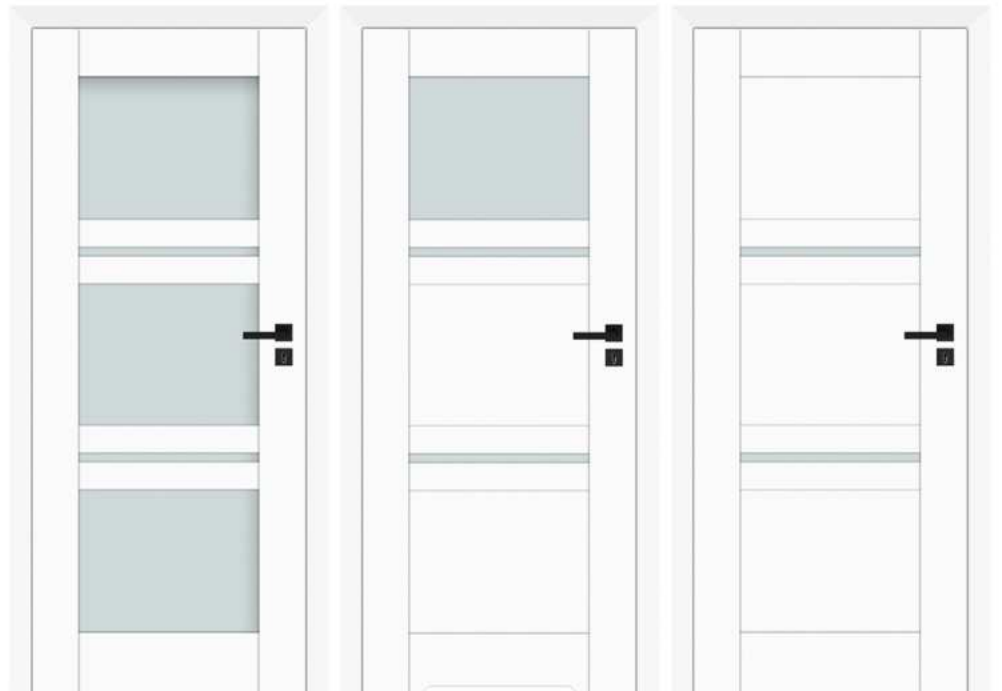

ROOM

BATHROOM

FULL





## FIORE//

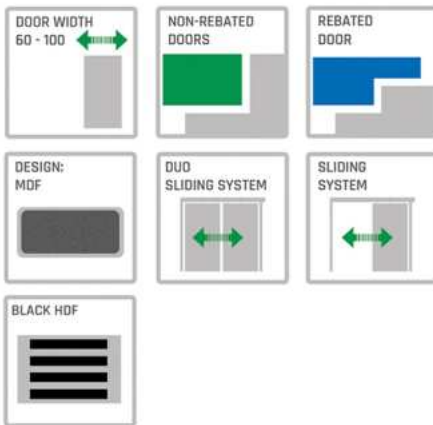

ROOM



BATHROOM



FULL



## DRACO//

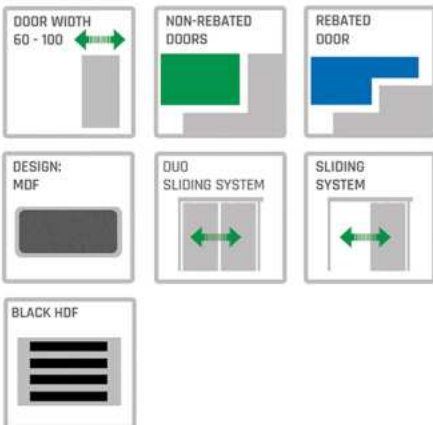

ROOM



BATHROOM



FULL





FUTURO//

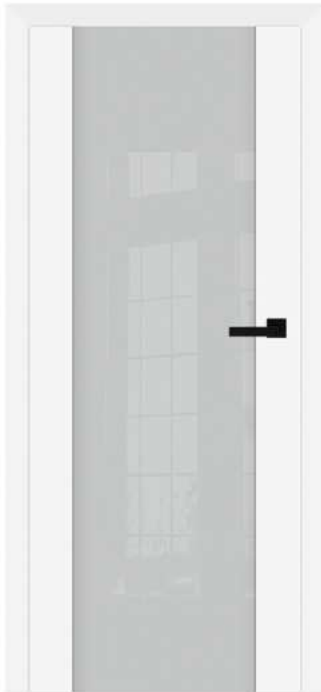

ROOM

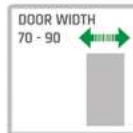

**BESTSELLER**

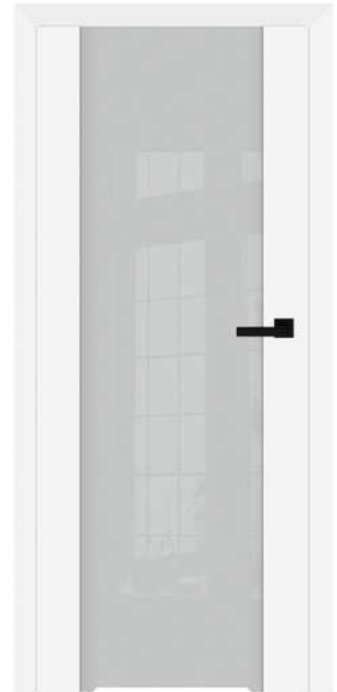

BATHROOM



CANIS//



AVAILABLE LEAF WIDTHS: 70, 80, 90

**LEAF CONSTRUCTION:**

- MDF FRAME COVERED WITH TWO HDF BOARDS
- STANDARD VERSION: HONEYCOMB CORE
- SOLID VERSION: WITH ACOUSTIC PANEL
- LEAF THICKNESS 39 MM

**DOOR HARDWARE:**

REBATED VERSION:

- 2 SCREWED-IN HINGES WITH 2D REGULATION
- LOCK: KEY, BATHROOM LOCK, INSERT OR ECONOMY LOCK

NON-REBATED VERSION:

- 2 SLOTTED HINGES (SUPPLIED WITH THE FRAME) - HONEYCOMB
- 2 CONCEALED HINGES (SUPPLIED WITH THE FRAME) - SOLID VERSION
- LOCK: MAGNETIC



HIDDEN HINGE  
NON-REBATED SOLID DOORS



SLOTTED HINGE  
NON-REBATED HONEYCOMB DOORS

**NEW! UNIVERSAL DOOR**

BY USING THE SLOTTED HINGES, THE CANIS LEAF IN THE NON-REBATED VERSION CAN BE INSTALLED AS A LEFT- OR RIGHT-HAND DOOR, ONLY WITH A DEDICATED FRAME.



SERPENS//



DOOR WIDTH 60 - 90

REBATED DOOR

DESIGN: HONEYCOMB

DUO SLIDING SYSTEM

SLIDING SYSTEM

**BESTSELLER**



ROOM

BATHROOM

FULL





**OLGA//**

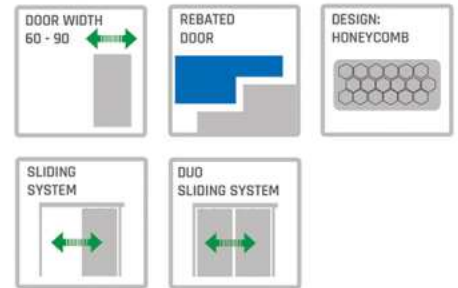

**ZETA//**

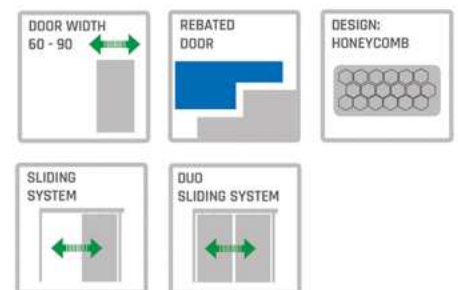

**TRIO//**

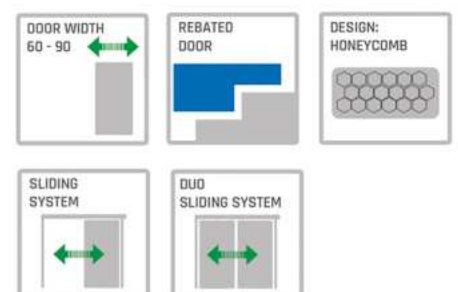

### ALBATROS//



ROOM

BATHROOM

FULL

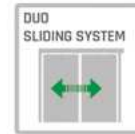
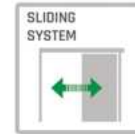
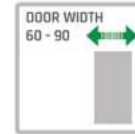

### ROCO//



ROOM

BATHROOM

FULL

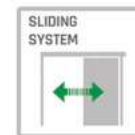
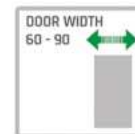

### CERES//



ROOM

BATHROOM

FULL

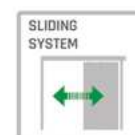
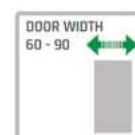



### MEMPHIS//

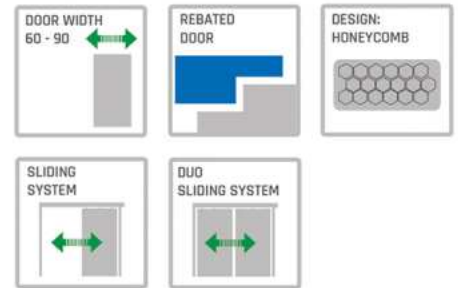

### PRESTO//

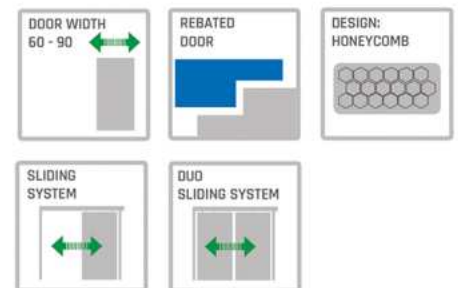

### KARINA//

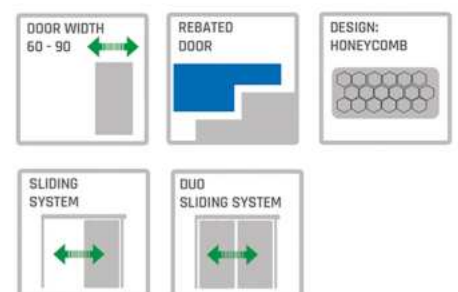
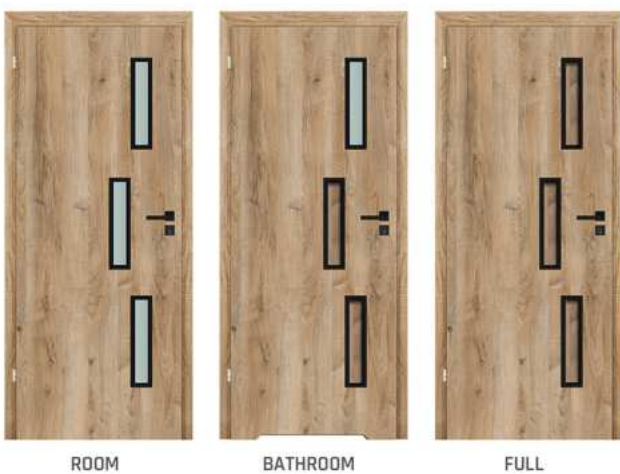

**CERES 2//**



ROOM

BATHROOM

FULL

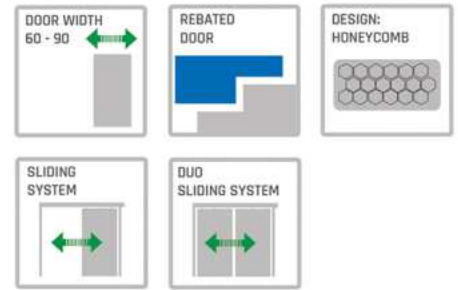

**CLASSIC//**



ROOM

BATHROOM

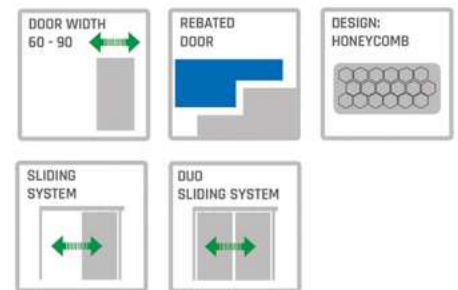

**WEGA//**



FRAME MADE OF 44 THICK MDF BOARD.

"HONEYCOMB" STABILIZATION FILLING.

FRAME AND FILLING ARE COVERED WITH HDF BOARD FROM BOTH SIDES.

LEAF DOOR FRAME MADE OF PVC IN THE SAME COLOUR AS WOOD.



LACQUERED DOORS//



ARIES FULL



ARIES BATHROOM



DORADO FULL



DORADO BATHROOM



GEMINI FULL



GEMINI BATHROOM



INDUS FULL



INDUS BATHROOM



LACQUERED DOORS

WHITE DOORS ARE PERFECT FOR MODERN ARRANGEMENTS AS WELL AS CLASSIC CONSTRUCTION, WHICH MAKES THEM TIMELESS. THE ADVANTAGES INCLUDE THEIR VERSATILITY AND EASY REPAIR OF DAMAGE.

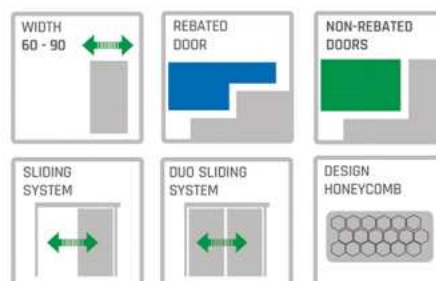

CALISTO//

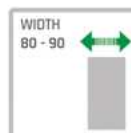

AVAILABLE WIDTHS: 80, 90

**EQUIPMENT:**

- FULL DOOR LEAF - REBATED SYSTEM
- MDF BOARD STILE COVERED WITH TWO HDF BOARDS
- 34 MM THICKNESS WITH SOLID SOURCE BOARD.
- LEAF THICKNESS 40 MM.
- HDF BOARD COVERED WITH FINISH FOIL
- 3 SILVER HINGES
- 2 LOCKS FOR A PATENT INSERT



ARA SET / TEA SET //



ARA SET MOUNTAIN OAK



TEA SET COUNTRY OAK

ARA/TEA DOORS ARE AVAILABLE WITH BLACK FRAME



SOUNDPROOF  
32 DB

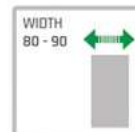

AVAILABLE WIDTHS: 80, 90.

EQUIPMENT:

- FULL DOOR LEAF - REBATED SYSTEM WITH FIXED DOOR FRAME
- FRAME DOOR FROM MDF BOARD COVERED WITH TWO HDF BOARDS
- 34 MM THICKNESS WITH SOLID SOUNDPROOFING BOARD.
- STEEL FLAT BAR REINFORCEMENT 4 MM.
- LEAF THICKNESS 46 MM.
- HDF BOARD COVERED WITH FINISH FOIL
- 4 SILVER HINGES Ø 16 WITH 3D ADJUSTMENT
- ALUMINUM THRESHOLD WITH A GASKET
- ADDITIONAL GASKET IN THE LEAF
- 2 PIN LOCKS IN A SINGLE KEY SYSTEM
- 3 ANTI-BURGLING BOLTS ON THE HINGE SIDE



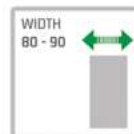

## ANDROMEDA SET//

SOUNDPROOF  
32 DB

AVAILABLE WIDTHS: 80, 90.

## EQUIPMENT:

- FULL DOOR LEAF - REBATED SYSTEM WITH FIXED DOOR FRAME
- FRAME DOOR FROM MDF BOARD COVERED WITH TWO HDF BOARDS
- 34 MM THICKNESS WITH SOLID SOUNDPROOFING BOARD.
- STEEL FLAT BAR REINFORCEMENT 4 MM.
- LEAF THICKNESS 46 MM.
- HDF BOARD COVERED WITH FINISH FOIL
- 4 SILVER HINGES Ø 16 WITH 3D ADJUSTMENT
- ALUMINUM THRESHOLD WITH A GASKET
- ADDITIONAL GASKET IN THE LEAF
- 2 PIN LOCKS IN A SINGLE KEY SYSTEM
- 3 ANTI-BURGLING BOLTS ON THE HINGE SIDE
- SET OF HANDLES WITH SLABS
- PANORAMIC VIEWFINDER.

ANDROMEDA INTERIOR DOOR CHARACTERIZES BY SIMPLE AND TIMELESS FORM. THIS MODEL IS DESIGNED FOR ALL KIND OF OFFICES AND OTHER SPACES.

THEY WILL PERFECTLY FITS IN THE ROOMS IN WHICH IS CONDUCTED SERVICE ACTIVITIES. SOLID WORKMANSHIP THIS IS ONLY ONE OF THE MANY ADVANTAGES.

DOORS RECOMMENDED FOR USE AS ENTRANCE FROM STAIRWAY TO FLATS.



## ORION SET//

SOUNDPROOF  
32 DB

AVAILABLE WIDTHS: 80, 90

## EQUIPMENT:

- FULL DOOR LEAF - REBATED SYSTEM WITH FIXED DOOR FRAME
- MDF BOARD STILE COVERED WITH TWO HDF BOARDS
- 34 MM THICKNESS WITH SOLID BOARD.
- REINFORCEMENT WITH A STEEL FLAT BAR THICKNESS 4 MM.
- LEAF THICKNESS 46 MM.
- HDF BOARD COATED WITH VARNISH
- 4 SILVER HINGES Ø 16 WITH 3D ADJUSTMENT
- ALUMINUM THRESHOLD WITH A GASKET
- ADDITIONAL GASKET IN THE LEAF
- 2 PIN LOCKS FOR A PATENT INSERT
- 3 ANTI-BURGLARY BOLTS ON THE HINGE SIDE

## AVAILABLE COLOURS:



WHITE PAINT



GRAY PAINT



## FIXED DOOR FRAMES//



Designed for rebated internal doors, the fixed frame consists of two main vertical beams (base) and one horizontal beam (header).

The fixed frame is equipped with:  
 - three screwed-in hinges  
 - rubber gasket

We recommend the additional masking elements consisting of a slat and quarter round for the fixed frame.



FIXED DOOR FRAMES



MASKING STRIP



QUARTER ROUND

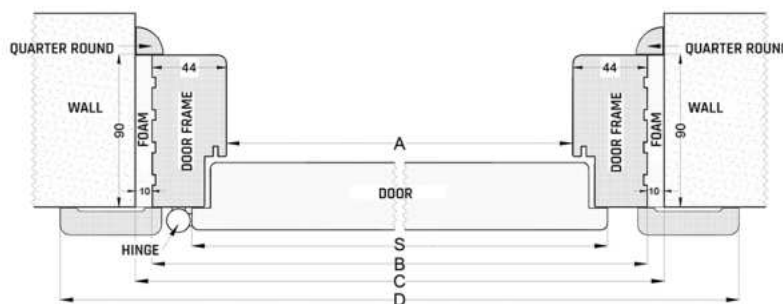
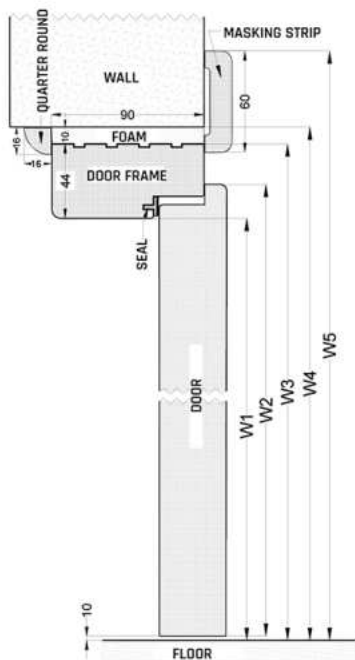
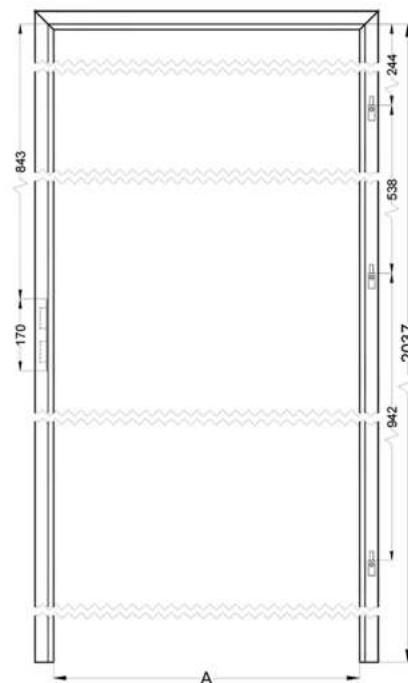

DIMENSIONS OF THE DOOR AND THE FIXED FRAME

DOOR	"60"	"70"	"80"	"90"	"100"	
S	FRAME/PANEL DOORS WIDTH	642/644	742/744	842/844	942/944	1042/1044
A	CLEAR WIDTH OF THE FRAME	599	699	799	899	999
B	EXTERNAL WIDTH IN THE FRAME	687	787	887	987	1087
C	WIDTH OF THE OPENING IN THE WALL	707	807	907	1007	1107
D	WIDTH OF THE DOOR FRAME WITH A MASKING STRIP	799	899	999	1099	1199
W1	CLEAR HEIGHT OF THE FRAME	2024				
W2	DOOR HEIGHT	2036				
W3	EXTERNAL HEIGHT OF THE FRAME	2068				
W4	HEIGHT OF THE OPENING IN THE WALL	2078				
W5	HEIGHT OF THE DOOR FRAME WITH A MASKING STRIP	2124				

## ADJUSTABLE REBATED DOOR FRAME//



Designed for rebated internal doors, the adjustable frame consists of two main vertical beams (base) and one horizontal beam (head).

The frame set includes three screwed-in hinges and a rubber gasket.

The front part on both sides consists of 6 cm or 8 cm wide flat masking casings.

Due to a wide range of regulation, the adjustable frame can be fitted in walls up to 64 cm thick.

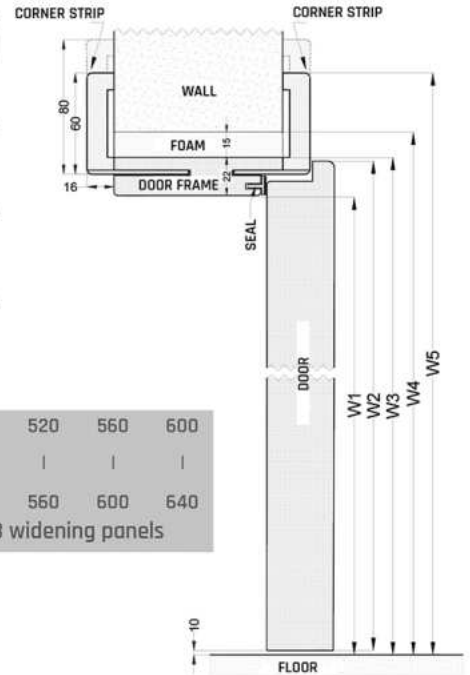

ADJUSTMENT RANGE (MM)

80	100	140	180	220	240	280	320	360	380	420	460	500	520	560	600
100	140	180	220	240	280	320	360	380	420	460	500	520	560	600	640
				1 widening panel				2 widening panels				3 widening panels			

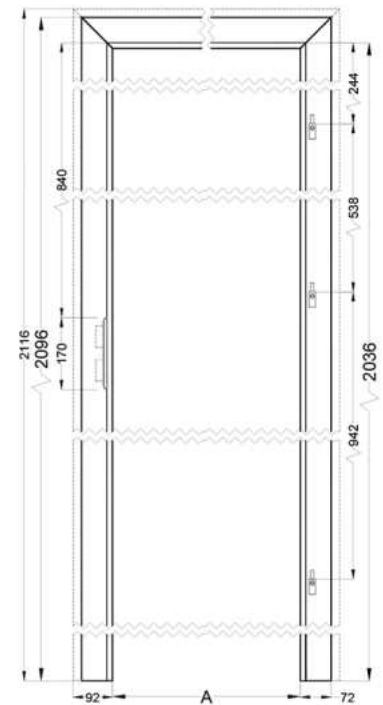
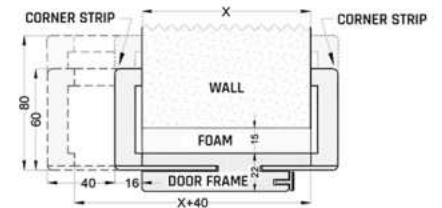
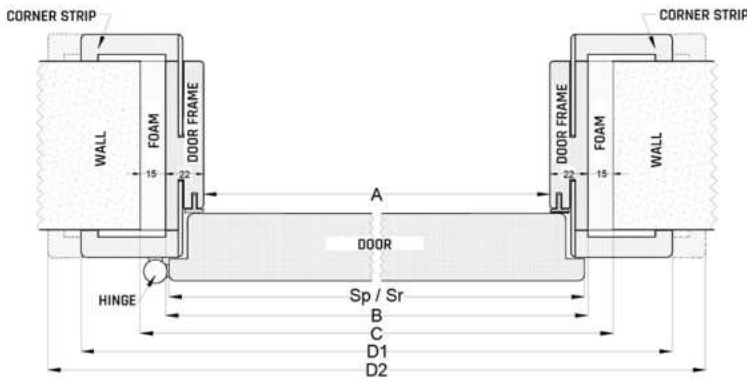

DIMENSIONS OF THE DOOR AND PANEL FRAME - REBATED DOORS

DOOR		"60"	"70"	"80"	"90"	"100"
S	FRAME/PANEL DOORS WIDTH	642/644	742/744	842/844	942/944	1042/1044
A	CLEAR WIDTH OF THE FRAME	599	699	799	899	999
B	EXTERNAL WIDTH IN THE FRAME	643	743	843	943	1043
C	WIDTH OF THE OPENING IN THE WALL	673	773	873	973	1073
D	WIDTH OF THE DOOR FRAME WITH A MASKING STRIP 60/80	743/783	843/883	943/983	1043/1083	1143/1183
W1	CLEAR HEIGHT OF THE FRAME	2026				
W2	DOOR HEIGHT	2036				
W3	EXTERNAL HEIGHT OF THE FRAME	2048				
W4	HEIGHT OF THE OPENING IN THE WALL	2063				
W5	HEIGHT OF THE DOOR FRAME WITH A MASKING STRIP 60/80	2096/2116				



## ADJUSTABLE NON-REBATED DOOR FRAME//



Designed for non-rebated internal doors, the adjustable frame consists of two main vertical beams (base) and one horizontal beam (head).

The frame set includes two concealed hinges ( a third hinge can be ordered) and a rubber gasket.

The front part on both sides consists of 6 cm or 8 cm wide flat masking casings.

Due to a wide range of regulation, the adjustable frame can be fitted in walls up to 63 cm thick.

### ADJUSTMENT RANGE (MM)

80	95	115	135	155	175	195	215	235	255	275	295	315	335	355
95	115	135	155	175	195	215	235	255	275	295	315	335	355	375
1 widening panel														
375	395	415	435	455	475	495	515	535	555	575	595	615	635	
395	415	435	455	475	495	515	535	555	575	595	615	635	655	
2 widening panels						3 widening panels								

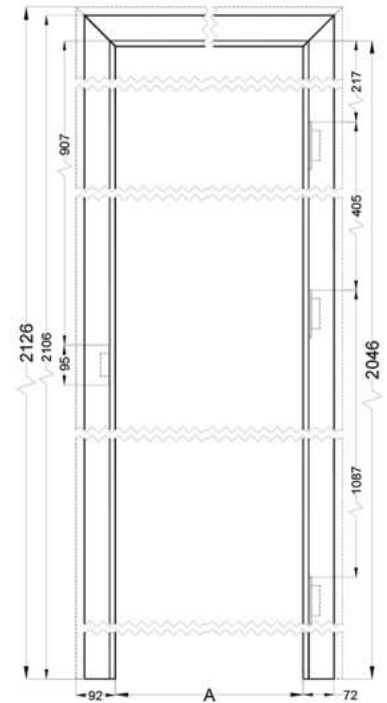
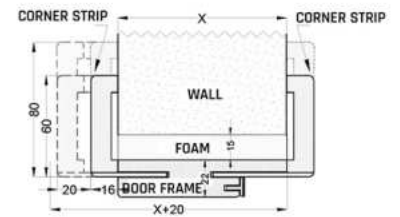
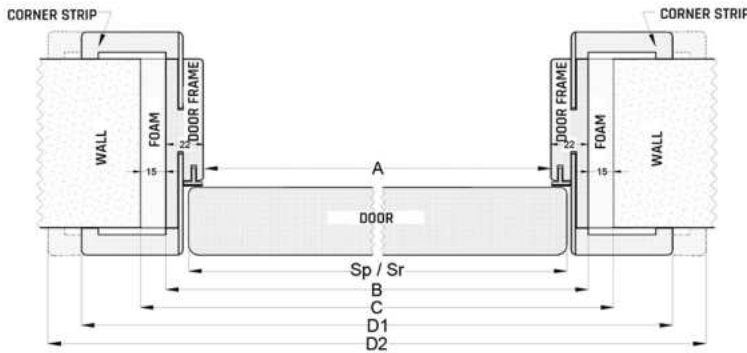
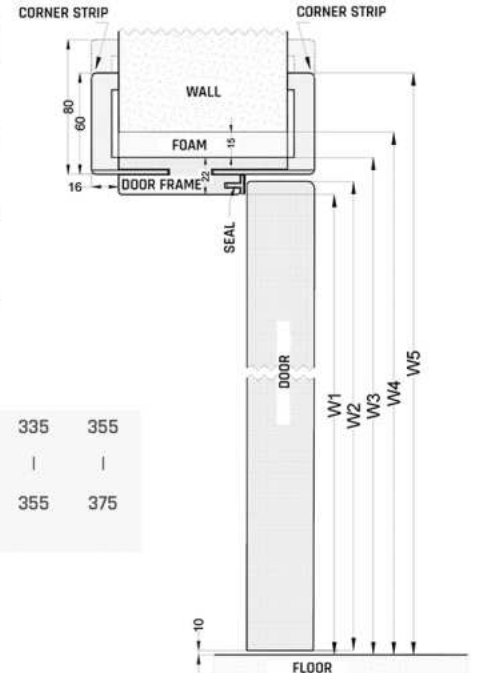

### DIMENSIONS OF THE DOOR AND PANEL FRAME - NON-REBATED DOORS

DOOR		"60"	"70"	"80"	"90"	"100"
S	FRAME/PANEL DOORS WIDTH	642/644	742/744	842/844	942/944	1042/1044
A	CLEAR WIDTH OF THE FRAME	625	725	825	925	1025
B	EXTERNAL WIDTH IN THE FRAME	669	769	869	969	1069
C	WIDTH OF THE OPENING IN THE WALL	699	799	899	999	1099
D	WIDTH OF THE DOOR FRAME WITH A MASKING STRIP 60/80	769/809	869/909	969/1009	1069/1109	1169/1209
W1	CLEAR HEIGHT OF THE FRAME	2034				
W2	DOOR HEIGHT	2036				
W3	EXTERNAL HEIGHT OF THE FRAME	2056				
W4	HEIGHT OF THE OPENING IN THE WALL	2071				
W5	HEIGHT OF THE DOOR FRAME WITH A MASKING STRIP 60/80	2106/2126				

## SLIDING SYSTEM//



## WALL SLIDING SYSTEM

With the sliding system, a door leaf can be installed in rooms where a traditional door cannot or is not desired. The door leaf moves on aluminium guides above the door opening.

The aluminium guide (Fig. 1) is the main component of the sliding system. The set includes the rollers and the necessary mounting accessories. If you want to conceal the guide, we recommend the purchase of a cover.

The cover panel for the sliding system (fig. 2) serves as a curtain rod, covering the guide that is the main element of the sliding system. The set also includes a spacer bar and a bumper bar in the same veneer.



fig. 1

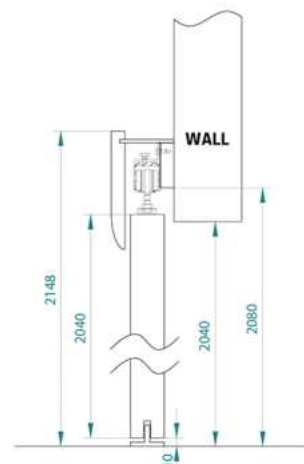

fig. 2

## WALL SLIDING SYSTEM DUO

With the DUO sliding system, it is possible to install two sliding leaves within one system, thus enabling the door to be fitted in a much wider opening in the wall.

The standard version of the aluminium guide, which like in the single system is the main element of the DUO sliding system, is equipped with an additional symmetric DUO mechanism, thus providing the effect of simultaneous sliding of both leaves.

HOOK LOCK  
ADDITIONAL FEE

## LAMELLAS//



THE 3L LAMELLA PANEL CONSISTS OF THREE 28 X 34 MM LAMELLAS ATTACHED TO A BLACK OR WHITE BOARD WITH DIMENSIONS 3 X 168 X 2750 MM.

### SYSTEM ELEMENTS:

3L LAMELLA PANEL  
37 X 178 X 2750 MM

LAMEL SET (START+END)  
37 X 84 X 2750 MM

SINGLE LAMELLA  
34 X 28 X 2750 MM

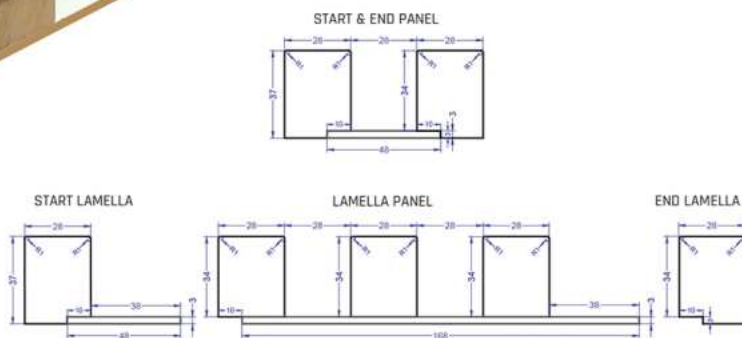

## BASEBOARD//

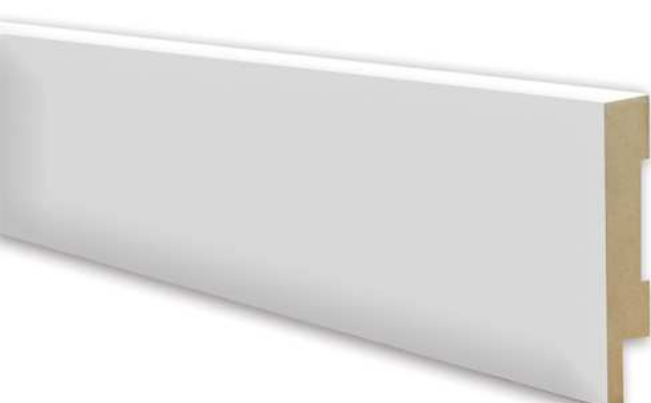

### AVAILABLE BASEBOARD:

- 2050 X 80 X 14 mm
- 2050 X 100 X 14 mm

A skirting board is a unique detail in every room, decorating the junction between the walls and the floor. Moreover, the strips perfectly mask unsightly cables, wires and expansion joints. WINDOOR skirting boards are available in the full colors of doors and frames.





# WINDOOR



REGION 1  
MOB. +48 503 040 395  
REGION1@WINDOOR.PL

REGION 2  
MOB. +48 505 298 449  
REGION2@WINDOOR.PL

REGION 3  
MOB. +48 511 948 514  
REGION3@WINDOOR.PL

REGION 4  
MOB. +48 504 722 807  
REGION4@WINDOOR.PL

## WINDOOR SP. Z O. O. - OFFICE

5 Zofii Holszańskiej Street  
26-600 Radom, POLAND

NIP: 7963015542 REGON: 524063880  
KRS: 0001011385 BDO: 000092664

biuro@windoor.pl

## WHOLESALE AND RETAIL SALES

65 Warszawska Street  
26-660 Wsola near Radom, POLAND

mob. +48 509 377 363

hurtownia@windoor.pl  
detal@windoor.pl